

BSX 63 & 66

INCREASED SAFETY FLUORESCENT LUMINAIRE



Mechanical Data

Material	: FRP & Polycarbonate
Weight	: Refer Chart below
IP Protection	: IP 65 as per IS-12063/1987 (IEC 60529/1989)
Finish	: Natural Grey
Cable Entry	: 2 x M20
Reflector	: MS white painted (Internal)
Suspension	: Type B or type G for pole / bracket mounting
Gasket	: Neoprene
Hardware	: Stainless Steel (SS-304)

Electrical Data

Voltage	V	: 230 V AC , 50 Hz
Lamp		: Fluorescent Tube Light (FTL)
Ballast	W	: High efficiency energy saving electronic ballast (1 x 18 or 2 x 18 W)
Lamp Holder		: Bi-pin rotor holder
Wiring		: PVC Insulated 1.5 sq.mm Stranded copper
Int. Terminations		: 2 sq.mm crimping lugs
Earthing		: Internal 1 No - M5

Description

Increased safety fluorescent luminaire with the construction of FRP body and polycarbonate transparent cover and with 8 nos of stainless steel self locking clamps. An MS white painted reflector housing the ballast is connected with terminals. Holders are fixed at both ends for shock absorption and effective holding of the lamp. Polyurethane foam gaskets provide a high degree of weatherproof protection.

GA Drawing

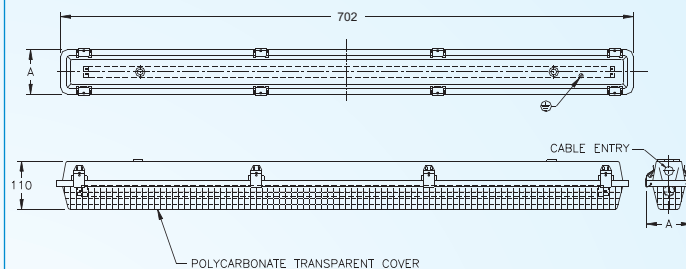

MATERIAL :

BODY : FRP (GLASS FIBRE REINFORCED POLYESTER)	REFLECTOR : MS WHITE PAINTED
COVER : POLYCARBONATE (TRANSPARENT)	VOLTAGE - 230V ±5%
CHOKE : ELECTRONIC CHOKE -1x40W	HARDWARES -SS 304

FIXTURES COMPLY WITH SEISMIC SPECIFICATION T12.730.543
 TERMINAL - 3WAY TERMINAL BLOCK SUITABLE FOR 2.5SQMM COPPER CABLE (ANTI-VIBRATION)

Cat.No.	A
BSX 63	102 mm
BSX 66	172 mm

All dimensions are in mm

Type of protection	Increased safety - Exe
Area Classification	Zone 2
Gas Groups	Group II A ,II B & II C
Apparatus Standard	IS 6381 & IS 8224
CMRI Certificate No.	CMRI / TC / P / H 1037
Approvals	CCE,BIS

Catalogue No	Wattage Rating	Temp. Rating	Weight (Kg)
BSX 63	1 x 18 / 1 x 20 W	T6	1.9 (Approx.)
BSX 66	2 x 18 / 2 x 20 W	T6	2.3 (Approx.)

Suspension (Optional)

TO SUIT NOMINAL DIA OF PIPE

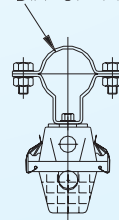

TYPE-G (POLE)

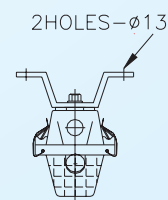

TYPE-B (BRACKET)

IF IN DOUBT ASK

DO NOT SCALE

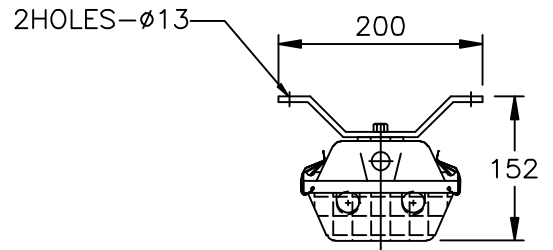
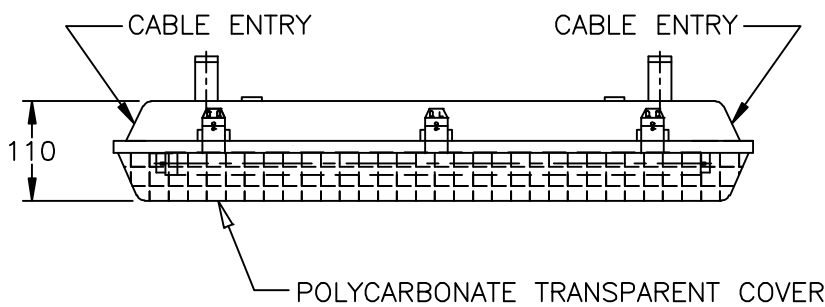
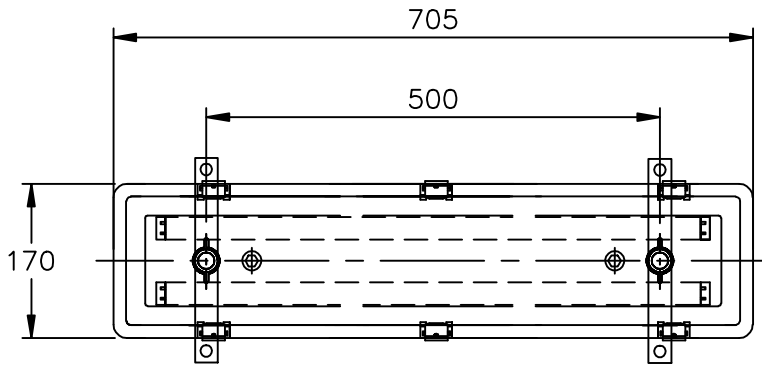

NOTES:

LAMP - 2x18W FLUORESCENT LAMP

TERMINAL - 1No. 3WAY TERMINAL BLOCK SUITABLE FOR 2.5SQMM COPPER CABLE (ANTI-VIBRATION)

MATERIAL :

BODY : FRP (GLASS FIBRE REINFORCED POLYESTER)

COVER : POLYCARBONATE (TRANSPARENT)

REFLECTOR : MS WHITE PAINTED

CHOKE : ELECTRONIC CHOKE

HARDWARE -SS 304

WIRING DIAGRAM

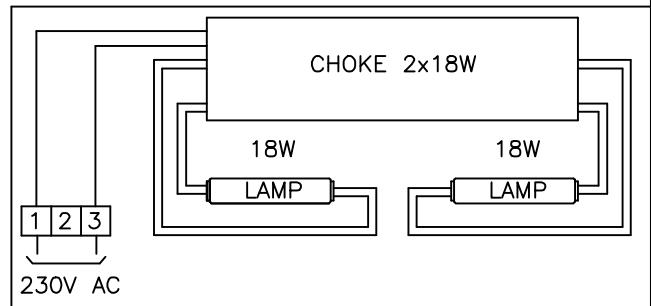

ALL DIMENSIONS ARE IN MM.

CABLE ENTRY: 2Nos. 0.75 ET	CUSTOMER : -		TITLE : INCREASED SAFETY TWIN FLUORESCENT LIGHT FITTING			
	CONSULTANT : -		CAT No. : BSX-66			
	PROJECT : -		CLASSIFICATION: Exe IP65 ZONE 2			
	FINISH : GREY		WT: 3.75KGS (APPROX.)	MATL: REF.NOTE	ITEM No.:	QTY.:
			TOLERANCE : ±5mm		FOR APPROVAL	
		SCALE N.T.S				
CMRI : CMRI/TC/P/H1037 DT:21.11.2003		IS :13947/93	NAME	DATE		
		IS :6381/72		REV-1		
				REV-2		
				DRN. R.M 26.11.08	DRG. No.	
				CHKD.	QEBSX66001	
				APPD.	0	



Baliga Lighting Equipments Private Limited,
 KOVILAMBAKKAM, CHENNAI-600 117, INDIA.