

BALIGA METER RUN ASSEMBLY

Meter run is used for critical flow measurement for low pressure and low temperature lines. Meter run is recommended for line size less than 50 NB(2). In this arrangement, flow measurement up to 400°C is possible without affecting transmitter diaphragm. Both upstream/downstream pipes of meter run are provided with end flanges/coupling to enable easy installation in the pipeline. Bore sizing is carried out as per ASME standard.

Recommended tapings: 1. Corner taps 2. Flange taps

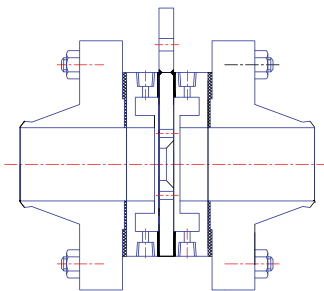
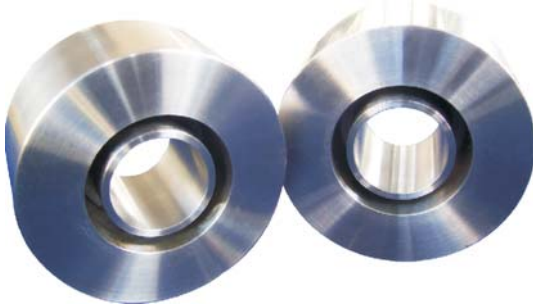
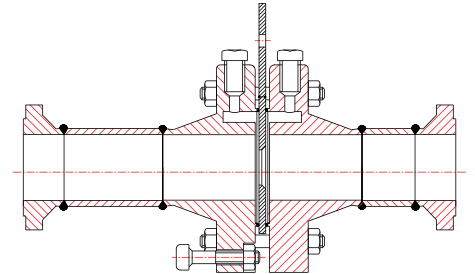

BALIGA CARRIER RING PLATE ASSEMBLY

Carrier Ring plate assembly is recommended for line size less than 50NB (2) and teflon coated or FRP pipe lines.

Material of construction: Carbon Steel / Stainless Steel / Monel.

BALIGA MULTISTAGE RESTRICTION ORIFICE

While single restriction orifices are often sufficient to meet the requirements, there are situations where limitations arise due to process conditions making the single restriction orifices unacceptable. In such situations, use of multiple restriction in series, is a better solution.

The foremost consideration for the case of multiple restrictions is the pressure drop. This applies whether or not the fluid is liquid or vapour/gas. Higher pressure drop implies higher velocities resulting in vibration and noise problems.

The other consideration is particularly for gas flow. If the process conditions indicate that critical flow will occur with the use of single restriction plate at which point sonic velocity is reached. In such case, multiple restriction plate will be used.

Baliga's expertise and software decides on spacing and configuration.

